

# ECO.80s+

## Magnetic drilling machine

**EUROBOOR**

FOR PROFESSIONALS BY PROFESSIONALS

### Technical data

	Metric	Imperial
Annular cutting	Ø 12 - 80 mm	Ø 1/2" - 3 1/8"
Twist drilling	Ø 1 - 31,75 mm	Ø 1/16" - 1 1/4"
Countersinking	Ø 10 - 85 mm	Ø 3/8" - 3 3/8"
Length	365 mm	14 3/8"
Width	310 mm	12 3/16"
Height	510 - 710 mm	20 1/16" - 27 15/16"
Stroke	260 mm	10 1/4"
Weight*	27.3 kg	60.2 lbs
Magnet (l x w x h)	220 x 110 x 64 mm	8 11/16" x 4 5/16" x 2 1/2"
Magnetic force	3,000 kg	6,615 lbs
Motor power	1,700 W	15.4 A
Total power	1,800 W	16.4 A
Speed (no load)		(I) 200 rpm (II) 300 rpm (III) 415 rpm (IV) 650 rpm
Speed (load 1,700 W, 15.4 A)		(I) 150 rpm (II) 200 rpm (III) 275 rpm (IV) 400 rpm
Spindle (Weldon)	MT3 19.05 mm	MT3 3/4"
Voltage	110 - 120 V / 60 Hz 220 - 240 V / 50 - 60 Hz	

\* Without power cord and handles

### Features



Overheat protection



Power surge protection



Power fluctuation protection



Gyro-Tec



Automatic shut-off



Oil lubricated gearbox



Carbon brush wear indicator



2-way magnet (TempTec)



Magnet LED-indicator (SensorTec)

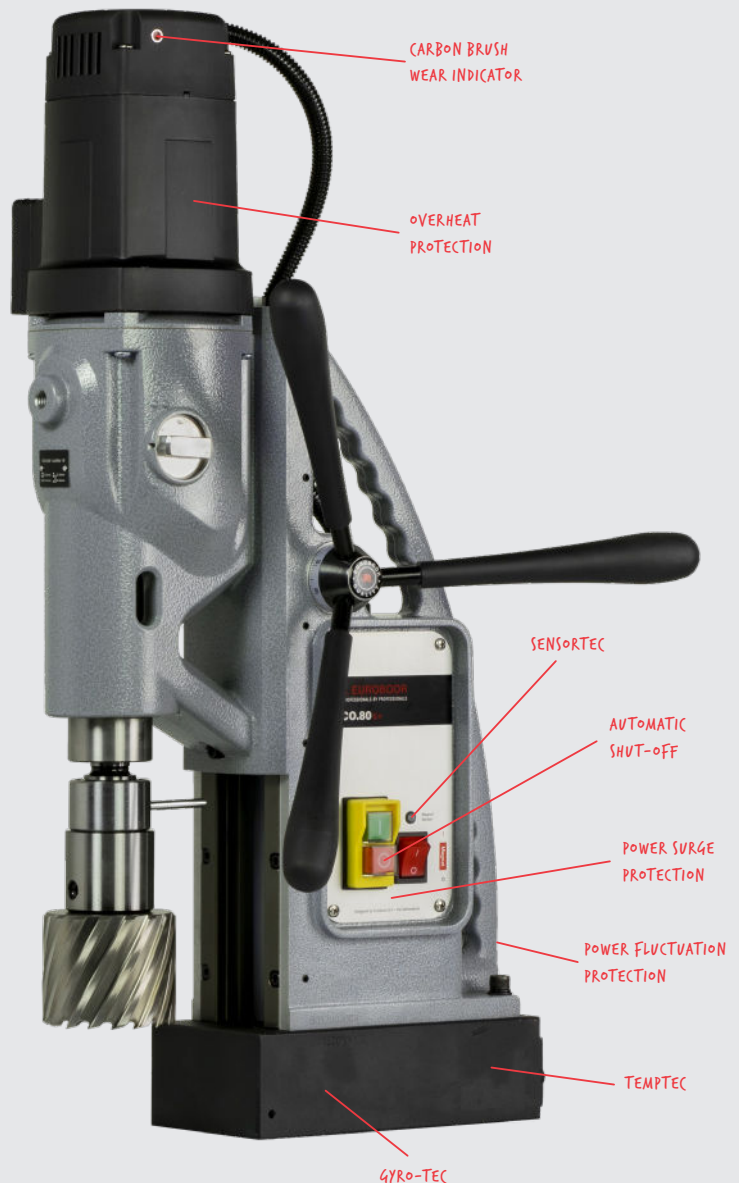
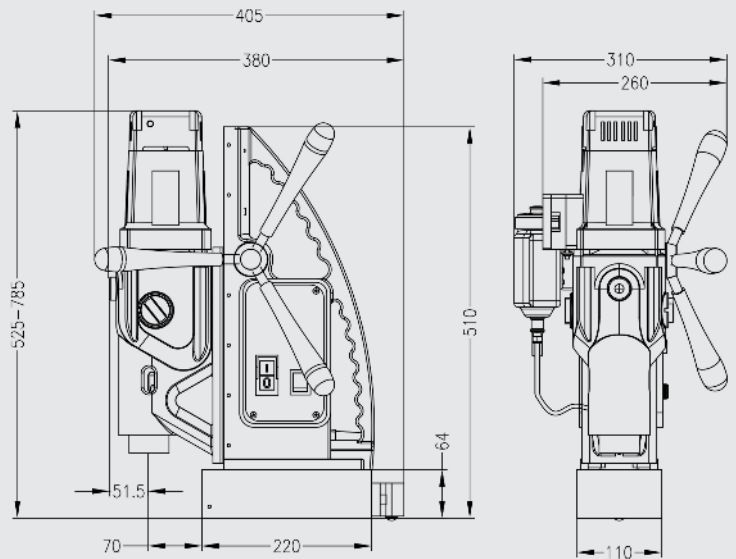

Euroboor makes every effort to meet quality and integrity requirements. That is why we as an organization are proud of the recognition of some leading organizations worldwide:



[www.euroboor.com](http://www.euroboor.com)